

# ASL Series Standard Pressure Transducer



**bf1systems**

The Competitive Advantage

The ASL Series of Standard Pressure Transducers have been designed for the detection of fluid and air pressures in demanding motorsport and automotive applications; ideal for high precision data acquisition or control systems. These transducers can be installed directly onto vehicles, or as part of a test stand or dyno.

Offering a high level of reliability and endurance, the ASL Series is protected against the high vibration, shock and high temperatures found in motorsport. With a modular construction and a programmable amplifier, this provides a large stock available of standard parts for fast delivery.

Pressure ranges are available between 2 to 200 Bar in either Absolute or Sealed Gauge reference, with an optional pressure port snubber to assist with filtering pressure spikes.

Industry standard 3-wire electrical connections allow configuration with most common ECU's and data logging systems. The ASL Series is race proven in many formulae around the world, offering a cost effective solution for professional engineers.

## Technical Specifications

<b>Pressure Reference</b>	Absolute & Sealed Gauge
<b>Pressure Ranges (Bar)</b>	2, 10, 35, 100 & 200
<b>Proof Pressure (Over Range)</b>	150% of Range
<b>Burst Pressure</b>	>300% of Range
<b>Accuracy</b>	±0.5% FS Combined Linearity & Hysteresis (CNLH)
<b>Thermal Accuracy</b>	Zero ±0.04% FS/°C (Sensitivity ±0.04% of Reading /°C)
<b>Output</b>	0.5V to 4.5V (±0.5%)
<b>Supply</b>	5V - 40V d.c. (Less than 20mA consumption)
<b>Operating Temperature Range</b>	-20°C to +135°C
<b>Compensated Temperature Range</b>	0°C to +125°C
<b>Construction</b>	Stainless Steel with either EPDM or Viton internal O-rings
<b>Electrical Connection</b>	50cm 26AWG, FEP Insulated Screened Cable
<b>Process Connection (Thread Sizes)</b>	Please see Part Number Configurator
<b>Protection Class</b>	IP67, Dust tight & water immersion to 1m for 30mins
<b>EMC Protection &amp; Vibration</b>	EN E50082-1 and Mil-Std-810C, Curve L, 20G
<b>Weight</b>	34g

bf1systems adopts a continuous development program which sometimes necessitates specification changes without notice.

## Features

- Compact Design
- 2 to 200 Bar Range
- Amplified Output
- Rugged Design
- ±0.5% Accuracy
- Optional Snubber

## Applications

- Coolant
- Brakes
- Water
- Boost
- Fuel
- Oil

## Contact Us:

bf1systems  
Unit 13 Springfield Business  
Park  
Priest Court  
Grantham  
Lincolnshire  
NG31 7FZ  
United Kingdom

+44 (0)1476 568057  
sales@bf1systems.com

# Part Number Configuration

**Pressure Reference**

**Pressure Range**

**Process Connection**

**O-Ring Material (Internal)**

**Special Code**

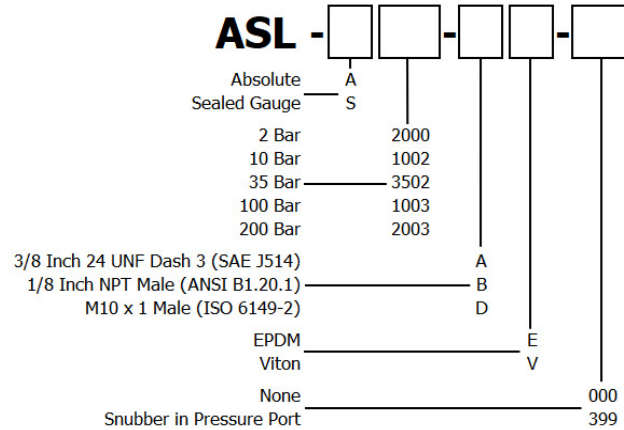

# Mechanical Details

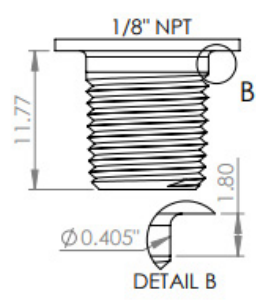
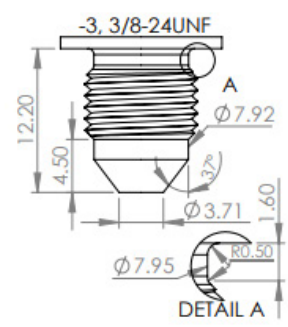
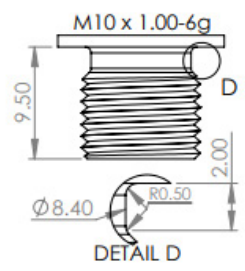
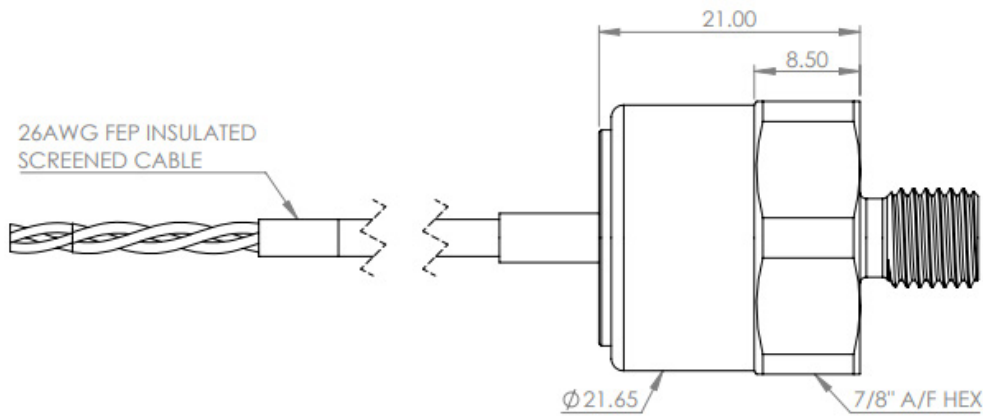

# Connection Details

+VE Supply	0V Supply	Signal
Red	Black	White

# Features

- Compact Design
- 2 to 200 Bar Range
- Amplified Output
- Rugged Design
- ±0.5% Accuracy
- Optional Snubber

# Applications

- Coolant
- Brakes
- Water
- Boost
- Fuel
- Oil

# Contact Us:

bf1systems  
 Unit 13 Springfield Business  
 Park  
 Priest Court  
 Grantham  
 Lincolnshire  
 NG31 7FZ  
 United Kingdom

+44 (0)1476 568057  
 sales@bf1systems.com